

How to use a face mask

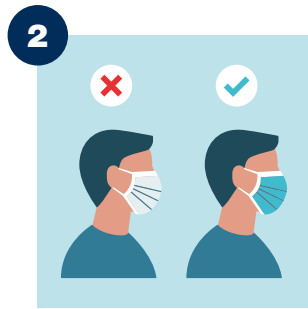

1 Wash or disinfect hands before touching or applying the mask.



2 Ensure the proper side of the mask faces outwards - it is usually colored.



3 Locate the nose piece and place it on the bridge of the nose.



4 Secure the earloops behind the ears.



5 Unfold the mask, making sure it fully covers the mouth and nose without gaps.



6 Pinch the nose piece to adjust it the shape of the nose.



7 Remove the mask from behind by the earloops. Avoid touching the mask.



8 Dispose of the mask in a closed trash can without touching the trash can.



9 Wash or disinfect hands.



Avoid touching the mask during use. If you do, wash or disinfect hands.



Replace the mask if it gets damp. Do not reuse it.